

Geolink Crossover

The Geolink crossover module is design to adapt to the PDT Rotary Pulser module. The existing Geolink negative pulse string can be converted into a Positive pulse using the Geolink crossover and the PDT I-pulser module. The module screws into the bottom of the rotary pulser, the rest of the geolink module can be assembly to the module and program as normal. The existing geolink surface gear can still be used to decode the pulses.

The Geolink transmitter and APC module in no longer require from the string.

The following equipment is required to run the I-Pulser tool:

Geolink crossover module, I-Pulse module with muleshoe sleeve
Top Landing UBHO sub (non mag)
Orienting tool, Pick-Up Plate, on/off overshot.
Set screws, Orifices - sizes - 1.28, 1.31, 1.35, 1.4, snap rings

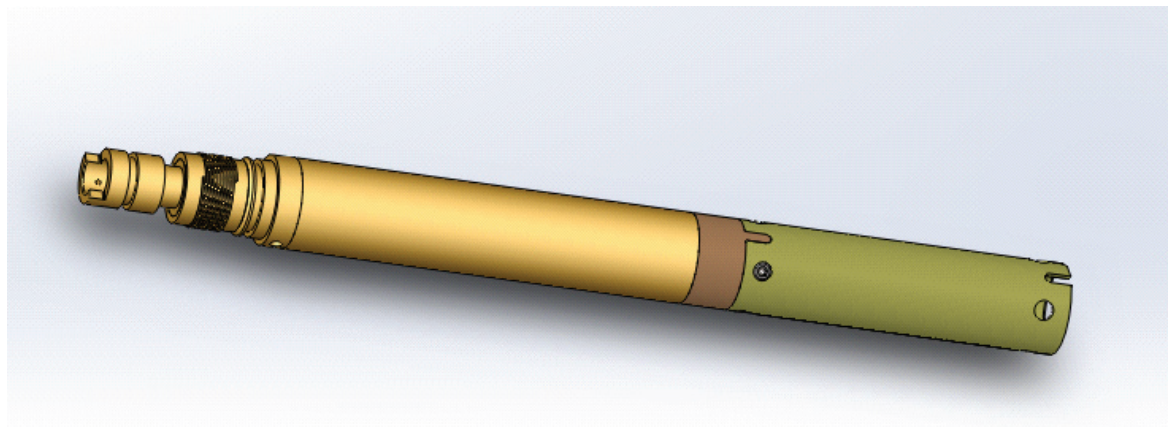

WE OFFER

MWD / LWD Drilling Services with
MWD specialists

MWD / LWD Kit Rental
daily / monthly

MWD / LWD Kit Sales – customize
your kit depending on your needs

Part Sales

MWD / LWD shop setups

MWD / LWD training

SERVICES

In-house Repairs & Tool Servicing

In-house Subs Repairs & Coating

In-house Engineering Technology
Development