

### Electro-Magnetic Technology (EM) Optional Annular Pressure Built-In

EM technology transmits data through the formation using electromagnetic energy that is decoded on surface. EM has no moving parts so it can be used in an air-drilling situation or high LCM environments where mud pulse tools are rendered inoperable. Surveys can be transmitted during connection with no waiting time at data rates exceeding 5 times faster than conventional mud pulse.

#### BENEFITS TO CUSTOMER

The newest generation transmitter is able to better adapt itself to the changing formations to provide a clearer and crisper signal. The Bottom Hole Assembly requires a double isolation sub that provides a redundant back up as well as providing better signal propagation. The orientation sub serves a dual purpose by providing a high side tool face and pressure readings. With the addition of our subs, your BHA assembly remains simplified and easy to maintain.

Filtering is done using our newest generation noise subtraction software. This software enables the user to drill deeper with less power by imputing the surface rig noise through a separate channel and subtracting from the noisy signal leaving a perfectly clear signal for decoding.

#### FEATURES

- Downlink availability
- Surveys can be transmitted during connection (under 60 seconds)
- Real Time Annular pressure and gamma capability
- Variable Transmission Time (tool face and gamma update 4 seconds)
- Wireline retrievable
- Variable transmitter power selection
- Variable frequency settings
- EM module is interchangeable with PDT Pulser for convenience

#### APPLICATIONS

- Underbalanced drilling
- Lost Circulation
- Noisy mud environment
- Fast drilling where speed is a factor.

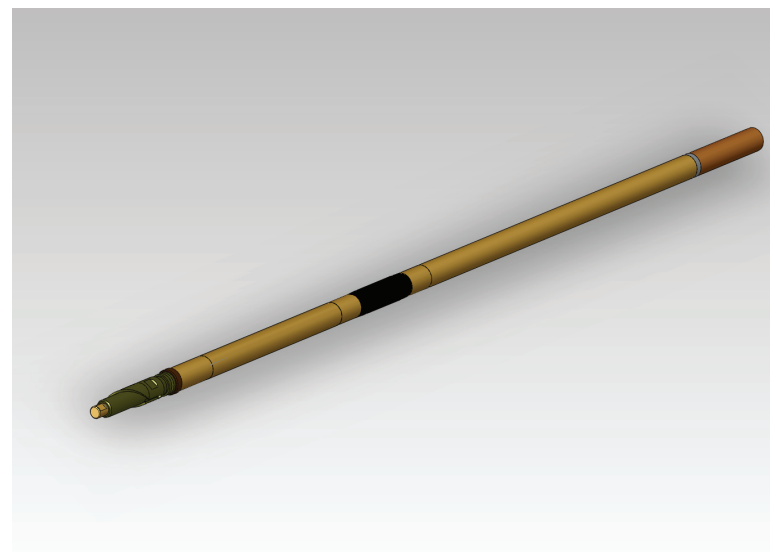

#### WE OFFER

MWD / LWD Drilling Services with MWD specialists

MWD / LWD Kit Rental daily / monthly

MWD / LWD Kit Sales – customize your kit depending on your needs

Part Sales

MWD / LWD shop setups

MWD / LWD training

#### SERVICES

In-house Repairs & Tool Servicing

In-house Subs Repairs & Coating

In-house Engineering Technology Development